

Tuffaloy threaded electrodes are Class 2 alloy. Other materials are available.

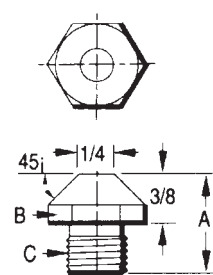
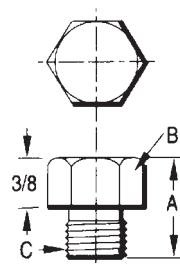
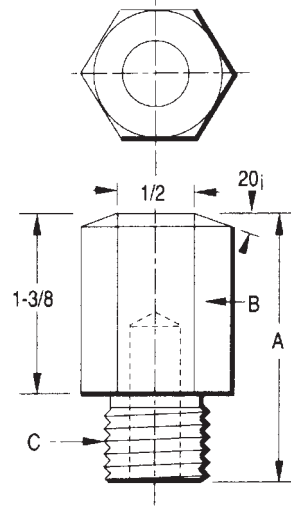
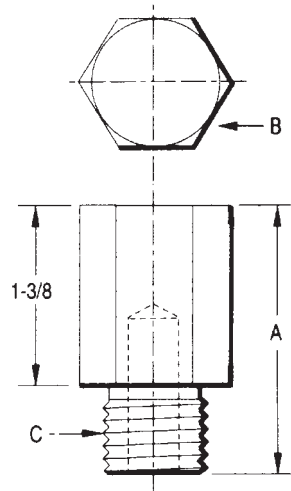

**FLAT ELECTRODES**

A Overall Length	B Tip Dia. (Hex)	C Male Thread	Description	Part No.
2	1	5/8-11	5100-11-C	187-5100-11
	1	5/8-18	5100-18-C	187-5100-18
	1	3/4-11	5100-10-C	187-5100-10
	1-1/4	3/4-10	5125-10-C	187-5125-10

**TRUNCATED ELECTRODES**

A Overall Length	B Tip Dia. (Hex)	C Male Thread	Description	Part No.
2	1	5/8-11	5100-11-E	188-5100-11
	1	5/8-18	5100-18-E	188-5100-18
	1	3/4-10	5100-10-E	188-5100-10
	1-1/4	3/4-10	5125-10-E	188-5125-10

**"C" NOSE ELECTRODES**

A Overall Length	B Tip Dia. (Hex)	C Male Thread	Description	Part No.
3/4	5/8	7/16-14	5062-14-C	187-5062-14
3/4	5/8	3/8-16	5062-16-C	187-5062-16

**"E" NOSE ELECTRODES**

A Overall Length	B Tip Dia. (Hex)	C Male Thread	Description	Part No.
3/4	5/8	7/16-14	5062-14-E	188-5062-14

